



SPS Sand Cannon

Sand Recovery System By DariTech

**Sand Recovery Systems by DariTech
For Flush or Flush Flume Operations**



What “separates” our Sand Recovery Systems from other sand separation equipment?

- Cleaner sand
- Low energy usage
- Less wear on equipment
- Less cost to purchase, operate and maintain
- Operates with broad range of sand sizing

Manufactured in the USA!
US Patent 8,470,183
& other patents applied for

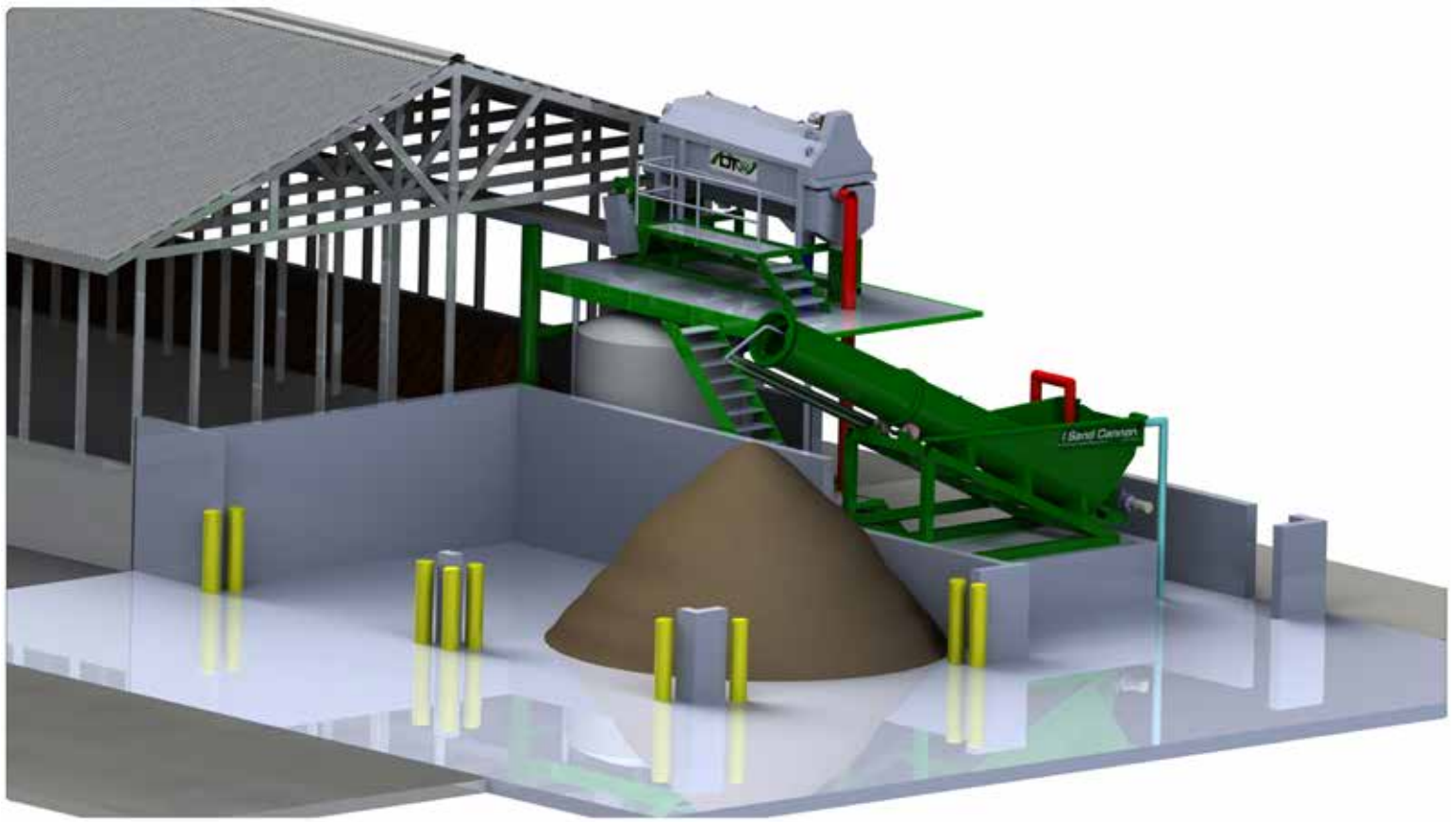

What sets our sand apart:

- Quality sand with low organics
- Separates finer sand
- Odor free sand
- No need for added equipment to remove water from sand because of low organics

What sets our equipment apart:

- Lower horsepower
- Less wear
- Cost efficient
- High quality construction
- Complete line to meet any dairy needs.

What sets our system apart:

- Less daily management
 - Easy start-up
- See back page for internal cutaway



High quality sand fresh out of our Sand Recovery System.



Control your equipment anywhere you go!

DariTech provides the *most complete* line of sand separation and process equipment in the industry. We strive to provide economical equipment with *high efficiency* and *low maintenance*.

Along with our choice of separators and augers, we offer our DT360 separators with our unique hybrid screen. The DT360 provides high quality process water and high fiber capture, giving the dairymen clean sand, clean fiber, and clean lagoons.

We also offer a full line of GreenLine pumps to complement our Sand Recovery System, providing excellent value with heavy duty, high wear resistance for pumping recycled water and sand laden manure.

In addition, we provide process control systems to meet the varied needs of system designs.

Whether you have 200 cows or 10,000 cows, DariTech has a system to meet your needs!

If you wish to keep solids out of the lagoon or send solids to the lagoon sand free, we have the solution!



**GreenLine Pumps:
Built to meet the demands
of sand systems.**



Scan here to watch
a video of the Sand
Cannon in action now!

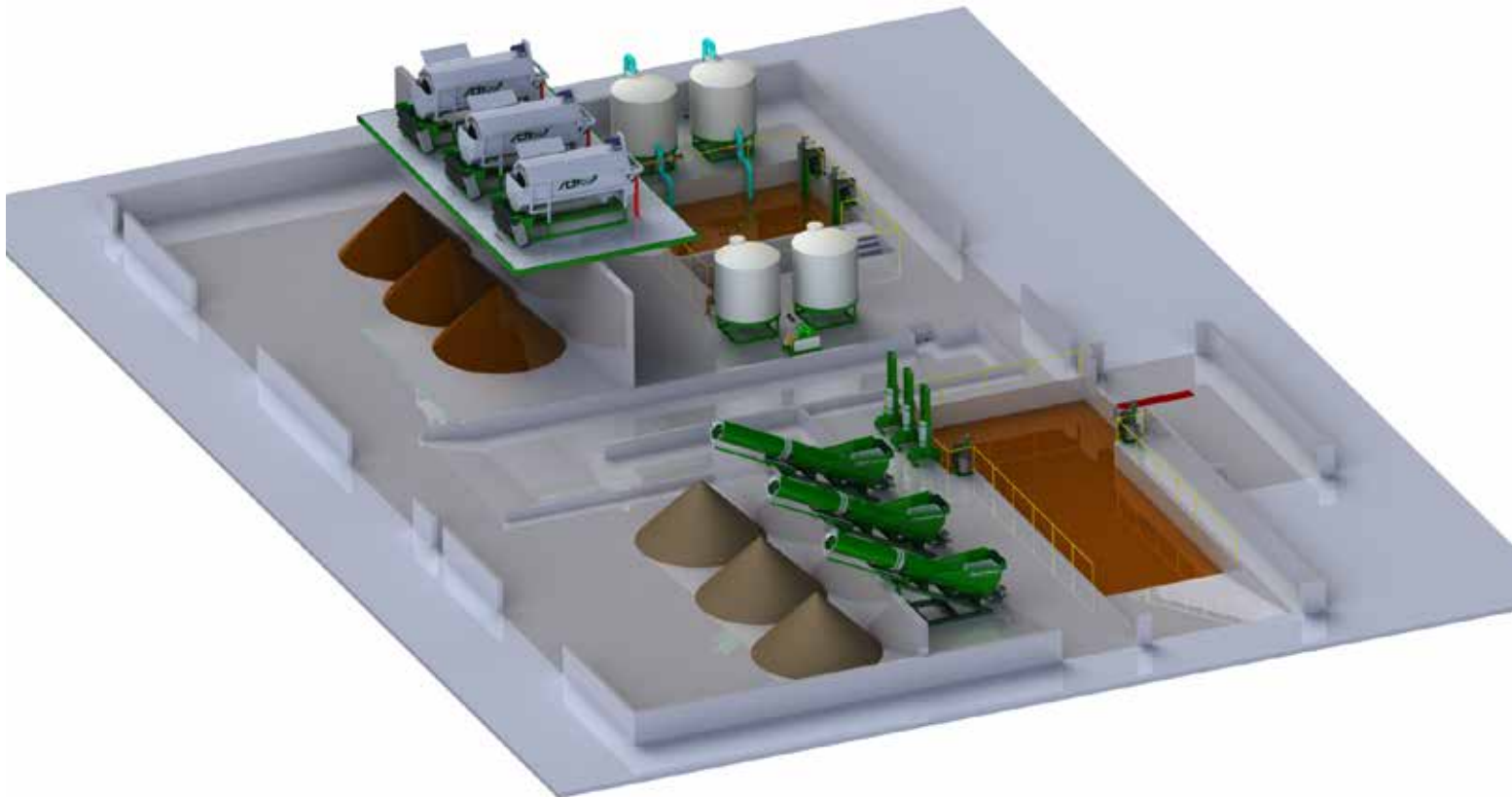

Unique design provides quality sand!

DariTech's One Shot and Sand Cannon use an internally flighted auger to lift, convey and clean sand laden manure. The internal auger uses less energy, and wear is greatly reduced by the sand being rolled uphill without the drag of conventional augers.

The internal flight of the DariTech SRS carries the settled sand and dirty water up the tube. With the flight attached to the wall of the tube, the sand is allowed to settle in the process of moving to the top. With the sand settled in the flight, the fiber and water escape through the split flights at the top (illustration "A") and cascade over the standard flights down the inside of the tube. Once the fiber and water reach the double flight (illustration "B"), the water and fiber exit the tube through the gapped double flight.

At the sand discharge end, with the vast majority of fiber removed, a small amount of water can easily finish cleaning the sand. Free of fiber, the rinsed, clean sand dries quickly without need of vibration or mechanical turning to prepare for bedding.

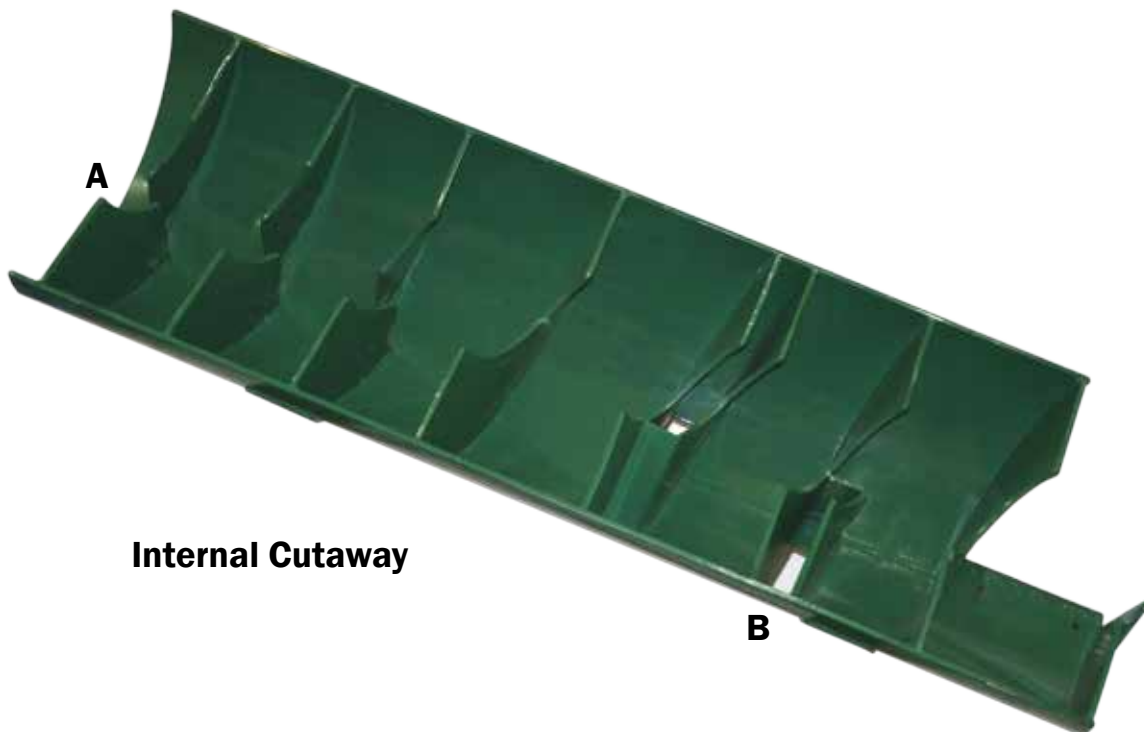

Internal Cutaway